

## STANDARD MUNTIN GRID FRAMES

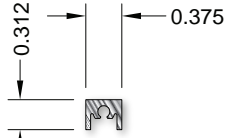

Eq. Leg Frame  
340419

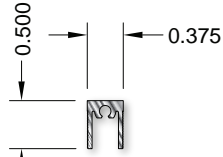

Frame Filler  
990290  
(For Series 3400)

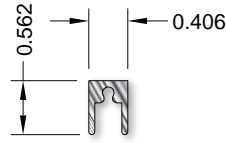

Frame Filler  
990427

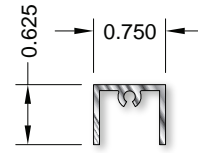

Frame Filler  
999412

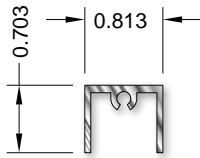

Frame Filler  
990343

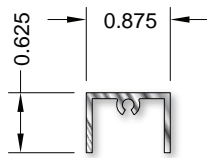

Frame Filler  
999402

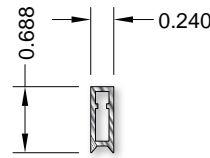

Frame Filler  
990899  
(Use Only With 990315  
Or 990871 Grid)

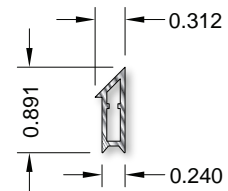

Frame Filler  
990388  
(Use Only With 990315  
Or 990871 Grid)

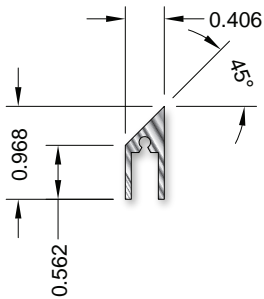

45° Beveled Filler  
990763

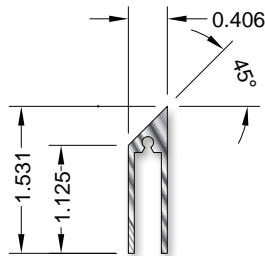

45° Beveled Filler  
990854

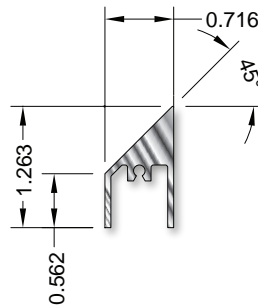

45° Beveled Filler  
990883

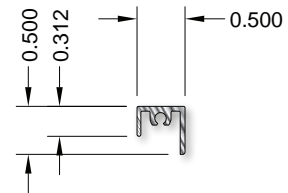

Frame Filler  
990487  
(For Series 3400)

**All Available Accessory  
Pieces Not Shown**

**Details Are Not Shown to Scale**

All available options not shown. For additional choices, please visit our website.

Check website for complete, current information including other installation and hardware options: [www.grahamwindows.com](http://www.grahamwindows.com)

1551 Mt. Rose Avenue, York, Pennsylvania 17403-2909 • email: [info@grahamwindows.com](mailto:info@grahamwindows.com) • (800) 755-6274 • 717-849-8100

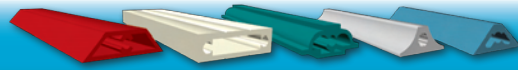

**STANDARD MUNTIN GRIDS**

**Applied Grid Options**

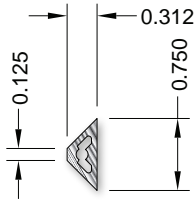

Trapezoidal  
990304/990315

[ Use 990315 With  
990388 Or 990899  
Grid Frame ]

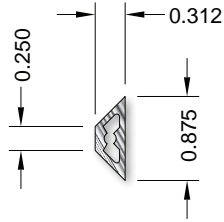

Trapezoidal  
990326

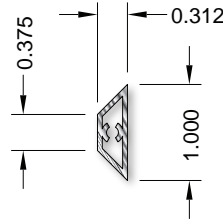

Trapezoidal  
990882

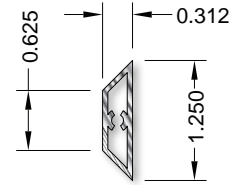

Trapezoidal  
990853/990871

[ Use 990871 With  
990388 Or 990899  
Grid Frame ]

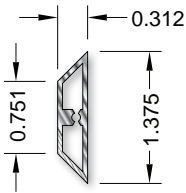

Trapezoidal  
990880

[ Use Only With  
990388 Or 990899  
Grid Frame ]

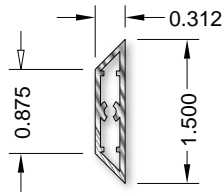

Trapezoidal  
990363

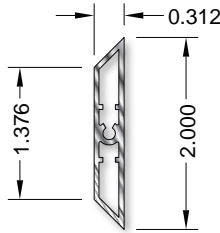

Trapezoidal  
990306

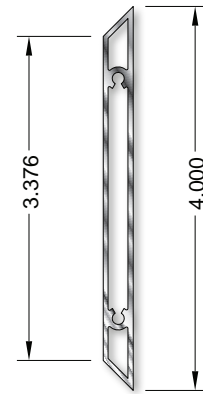

Trapezoidal  
990333

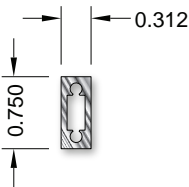

Tubular  
990312

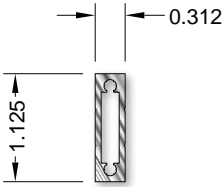

Tubular  
990310

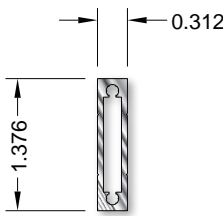

Tubular  
990314

**All Available Accessory  
Pieces Not Shown**

**Details Are Not Shown to Scale**

All available options not shown. For additional choices, please visit our website.

Check website for complete, current information including other installation and hardware options: [www.grahamwindows.com](http://www.grahamwindows.com)

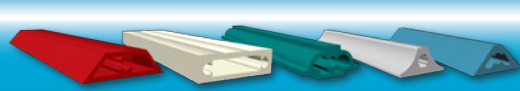

## STANDARD MUNTIN GRIDS

### Applied Grid Options

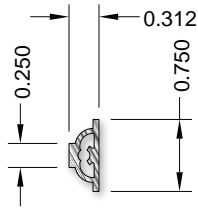

Profile  
990394/990392

Use 990392 With  
990899 Or 990388  
Grid Frame

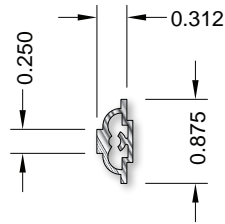

Profile  
990302

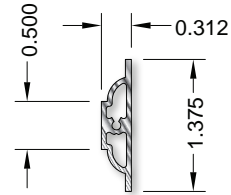

Profile  
990393/990391

Use 990391 With  
990899 Or 990388  
Grid Frame

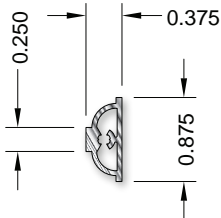

Profile  
990300

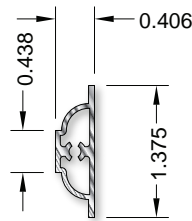

Profile  
990299

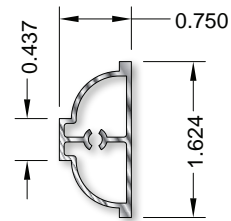

Profile  
990301

Use Only With  
990343, 990412 Or 990402  
Grid Frame

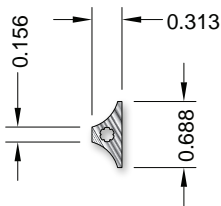

Concaved  
990364

### Muntin In Glass



Contoured  
8mm x 25mm  
950140

**All Available Accessory  
Pieces Not Shown**

**Details Are Not Shown to Scale**

All available options not shown. For additional choices, please visit our website.

Check website for complete, current information including other installation and hardware options: [www.grahamwindows.com](http://www.grahamwindows.com)

1551 Mt. Rose Avenue, York, Pennsylvania 17403-2909 • email: [info@grahamwindows.com](mailto:info@grahamwindows.com) • (800) 755-6274 • 717-849-8100

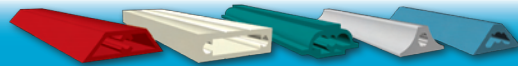

## HISTORIC MUNTIN GRID APPLICATIONS

Model 6700

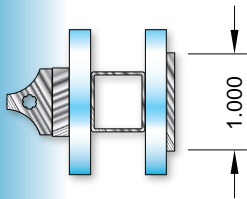

Triple  
With Concave  
1" IG Unit

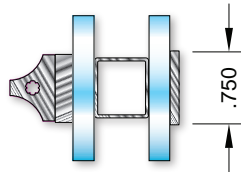

Triple  
With Trap  
1" IG Unit

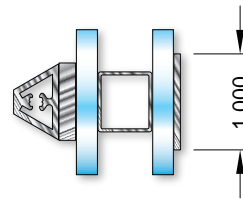

Model 2575H & 2275H

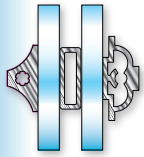

Triple With  
Concave Exterior  
Profile Interior  
5/8" IG Unit

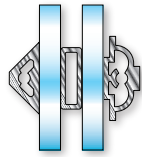

Triple With  
Trap Exterior  
Profile Interior  
5/8" IG Unit

Model 2575H, 2275H, 1450H, & 1550H

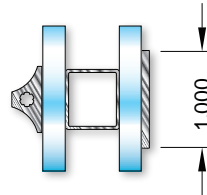

Triple  
With Concave  
1" IG Unit

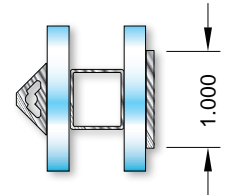

Triple  
With Trap  
1" IG Unit

Model 2075H

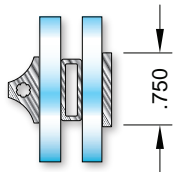

Triple  
With Concave  
5/8" IG Unit

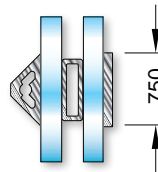

Triple  
With Trap  
5/8" IG Unit

**All Available Accessory  
Pieces Not Shown**

**Details Are Not Shown to Scale**

All available options not shown. For additional choices, please visit our website.

 Check website for complete, current information including other installation and hardware options: [www.grahamwindows.com](http://www.grahamwindows.com)

## TWIST-IN ANCHORS

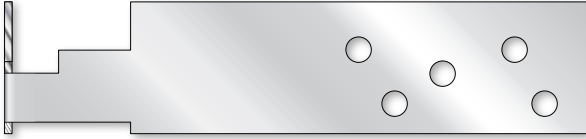

**928041** 1-3/8"  
Use With Window Series  
1500, 2200, 2500



**928042** 1-3/16"  
Use With Window Series  
0300, 1200, 2000

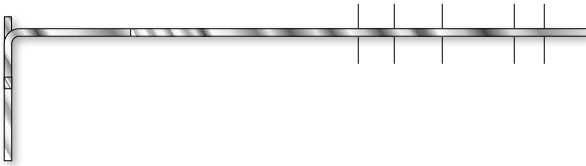

Twist-In Anchors Are Available Only On Select Frames In The Window Series Listed.  
Consult Technical Services At Factory For Availability.

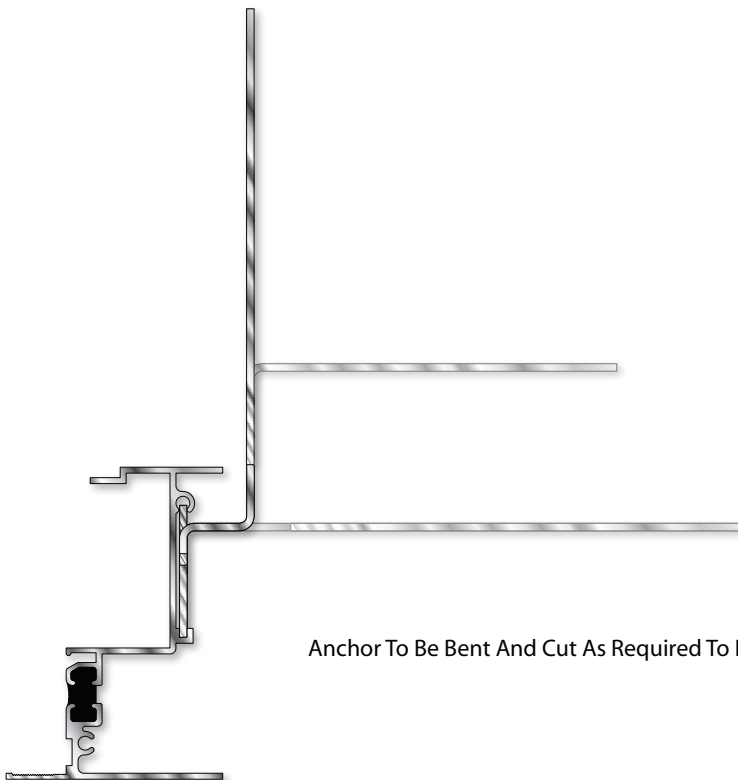

Anchor To Be Bent And Cut As Required To Fit Window Opening Condition

**Details Are Not Shown to Scale**

**All Available Accessory  
Pieces Not Shown**

All available options not shown. For additional choices, please visit our website.

 Check website for complete, current information including other installation and hardware options: [www.grahamwindows.com](http://www.grahamwindows.com)

1551 Mt. Rose Avenue, York, Pennsylvania 17403-2909 • email: [info@grahamwindows.com](mailto:info@grahamwindows.com) • (800) 755-6274 • 717-849-8100

## TWIST-IN ANCHORS



929140  
Use With Window Series  
6100, 6900

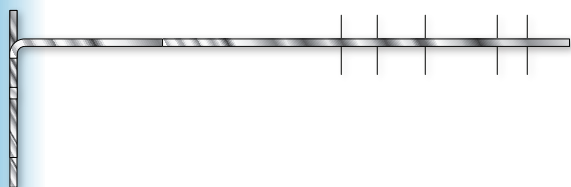

Twist-In Anchors Are Available Only On Select Frames In The Window Series Listed.  
Consult Technical Services At Factory For Availability.

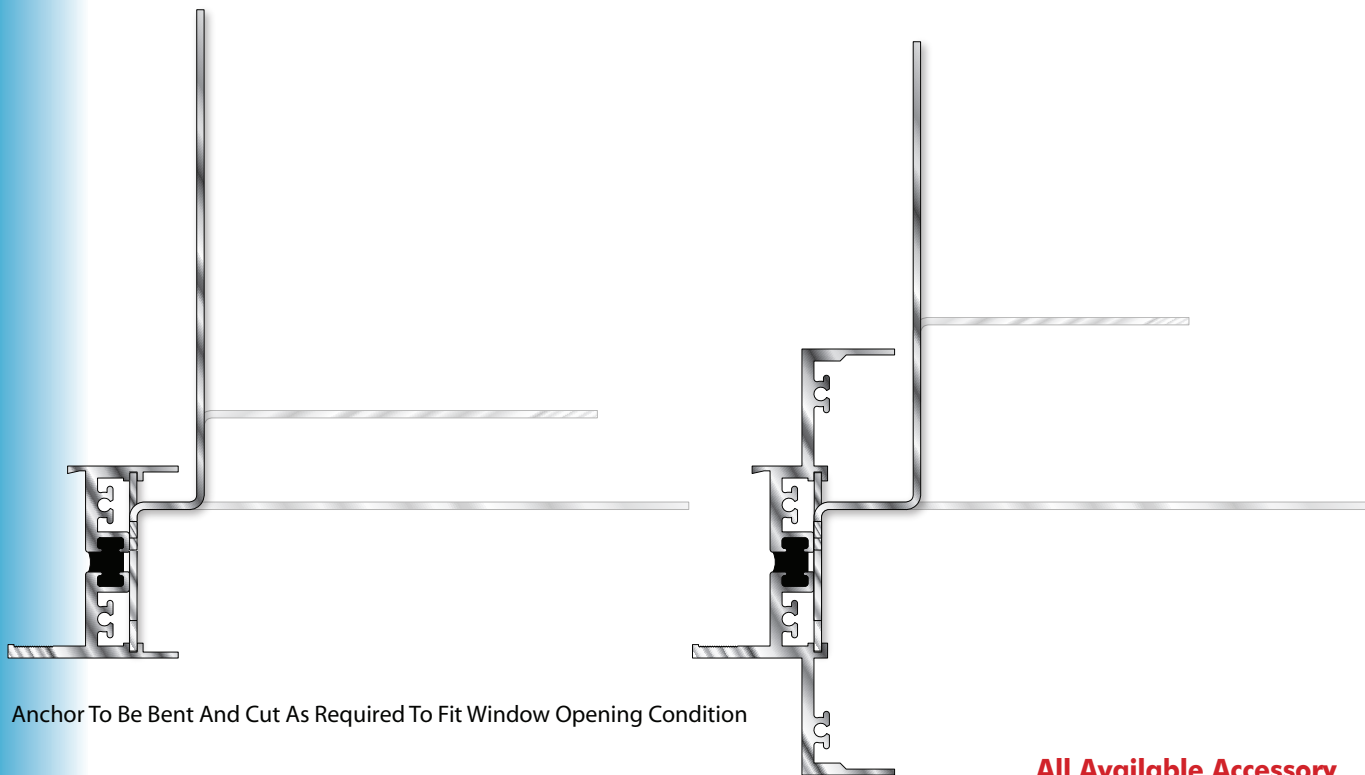

Anchor To Be Bent And Cut As Required To Fit Window Opening Condition

**All Available Accessory  
Pieces Not Shown**

**Details Are Not Shown to Scale**

All available options not shown. For additional choices, please visit our website.

 Check website for complete, current information including other installation and hardware options: [www.grahamwindows.com](http://www.grahamwindows.com)

## VINYL WINDOW ACCESSORIES

Note: Sealant not shown on details. Consult factory for sealing procedures.

980100  
Applied Flange

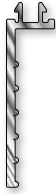

980105  
Applied Nailing Fin

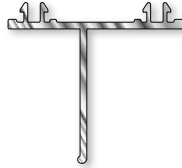

980109  
1/2" Mullion



980110  
1/16" Mullion



980111  
3 1/4" Frame Adaptor



**All Available Accessory  
Pieces Not Shown**

**Details Are Not Shown to Scale**

All available options not shown. For additional choices, please visit our website.

 Check website for complete, current information including other installation and hardware options: [www.grahamwindows.com](http://www.grahamwindows.com)

1551 Mt. Rose Avenue, York, Pennsylvania 17403-2909 • email: [info@grahamwindows.com](mailto:info@grahamwindows.com) • (800) 755-6274 • 717-849-8100

## ALCOA SILLS

Note: Sealant not shown on details. Consult factory for sealing procedures.

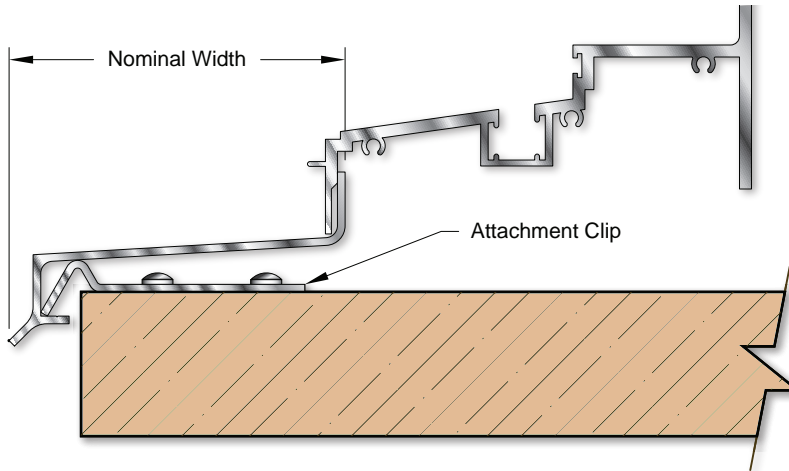

Nominal Width	Part Number
3 1/2"	999953
4"	999954
4 1/2"	999955
5"	999956
5 1/2"	999957
6"	999958

Alcoa Sills Typically Require Attachment Clip  
Part Number 999960 Provided In 2" Lengths

**All Available Accessory  
Pieces Not Shown**

**Details Are Not Shown to Scale**

All available options not shown. For additional choices, please visit our website.

 Check website for complete, current information including other installation and hardware options: [www.grahamwindows.com](http://www.grahamwindows.com)

## CAULK STOPS

Note: Sealant not shown on details. Consult factory for sealing procedures.

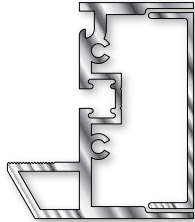

Caulk Stop 2 1/4" Products  
956701

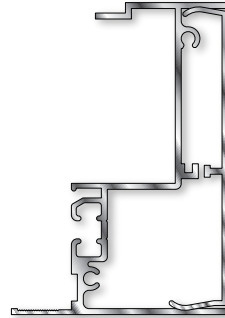

Caulk Stop 3 1/4" Products  
952001

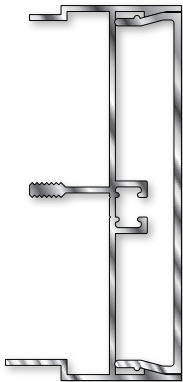

Caulk Stop 4" Products  
952201

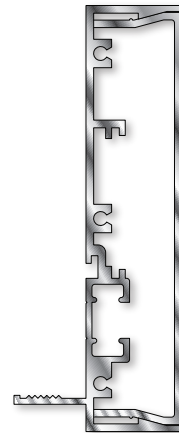

Caulk Stop 4 1/2" Products  
951501

**All Available Accessory  
Pieces Not Shown**

**Details Are Not Shown to Scale**

All available options not shown. For additional choices, please visit our website.

 Check website for complete, current information including other installation and hardware options: [www.grahamwindows.com](http://www.grahamwindows.com)

1551 Mt. Rose Avenue, York, Pennsylvania 17403-2909 • email: [info@grahamwindows.com](mailto:info@grahamwindows.com) • (800) 755-6274 • 717-849-8100

**EXPANDERS**



1" EXP.  
990801



1 1/2" EXP.  
990700



2 1/4" EXP.  
990701



3 1/4" EXP.  
990697



4 1/2" EXP.  
990706



1 1/8" W/DRIP CAP  
990695



1 5/8" EXP.  
990698



3/4" ANGLED EXP.  
990693



MAYFAIR EXP.  
990461



3/4"x5/8" EXP.  
990048



4 1/8" EXP.  
990696



3/4"x3/4" EXP.  
990049

**All Available Accessory  
Pieces Not Shown**

**Details Are Not Shown to Scale**

All available options not shown. For additional choices, please visit our website.

Check website for complete, current information including other installation and hardware options: [www.grahamwindows.com](http://www.grahamwindows.com)

## INTERIOR CASING

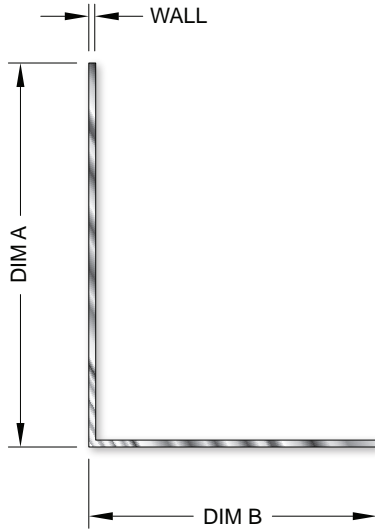

INTERIOR CASING

PART #	DIM A	DIM B	WALL
990060	4"	3"	0.072
990061	4"	5"	0.100
990062	4"	6"	0.110
990065	5"	5"	0.110

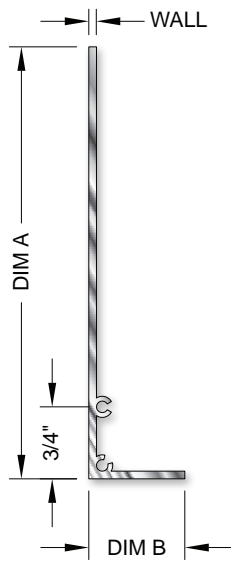

INTERIOR APRONS

PART #	DIM A	DIM B	WALL
990081	4 1/2"	1"	0.080

END CAP FOR ABOVE #929981 2 EA / PIECE  
ATTACHMENT SCREWS #939097 4 EA / PIECE

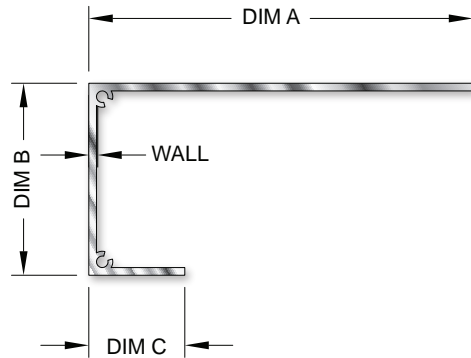

INTERIOR STOOL COVERS

PART #	DIM A	DIM B	DIM C	WALL
990086	4"	2"	1"	0.080
990087	6"	2"	1"	0.094

END CAP FOR ABOVE #929986 2 EA / PIECE  
ATTACHMENT SCREWS #939097 4 EA / PIECE

**All Available Accessory  
Pieces Not Shown**

**Details Are Not Shown to Scale**

All available options not shown. For additional choices, please visit our website.

 Check website for complete, current information including other installation and hardware options: [www.grahamwindows.com](http://www.grahamwindows.com)

## MULL COVERS

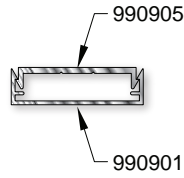

1 3/8"

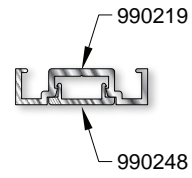

1 3/8"

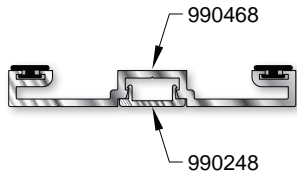

3"

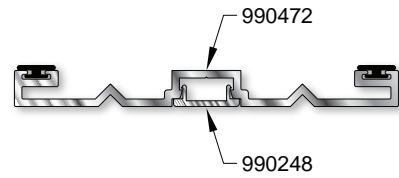

4"

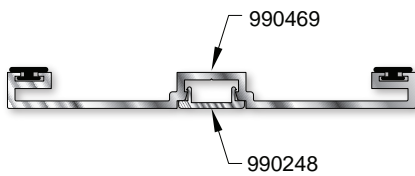

4 1/4"

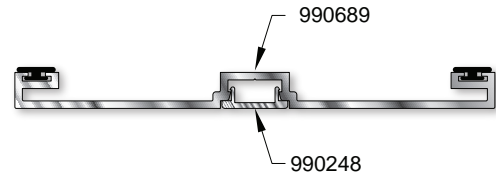

5"

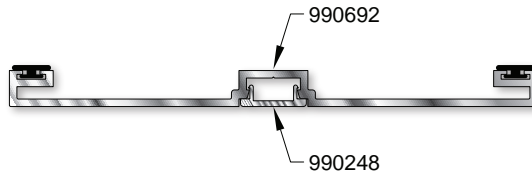

5 1/2"

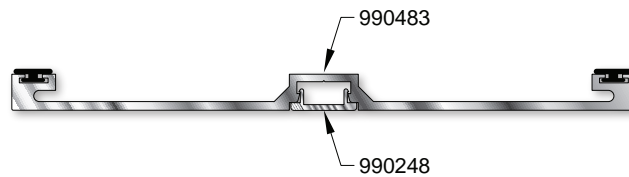

6 1/2"

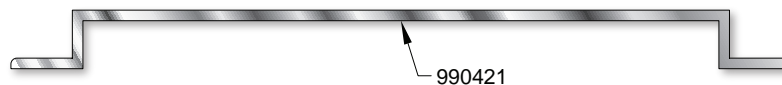

6 5/8"

**All Available Accessory  
Pieces Not Shown**

**Details Are Not Shown to Scale**

All available options not shown. For additional choices, please visit our website.

 Check website for complete, current information including other installation and hardware options: [www.grahamwindows.com](http://www.grahamwindows.com)