

Graham



Architectural Products

Hurricane Impact - 4"

Fixed

Tested To +100DP/-150DP (Large Missile)

Series: HI1400

Manufacturing Code: HI1402

Drawing 1/2 Scale - For Custom Size Drawing Contact Graham

Note: Sealant Not Shown On Details. Consult Technical Services At Factory For Sealing Procedures.

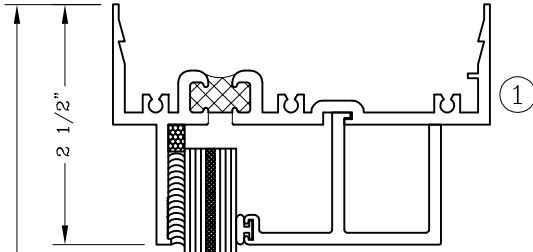

Glazing To Be:
9/16" Lami Consisting Of;
1/4" Thick Heat Strengthened Exterior,
.075 Storm Glass Interlayer (Solutia),
1/4" Thick Heat Strengthened Interior

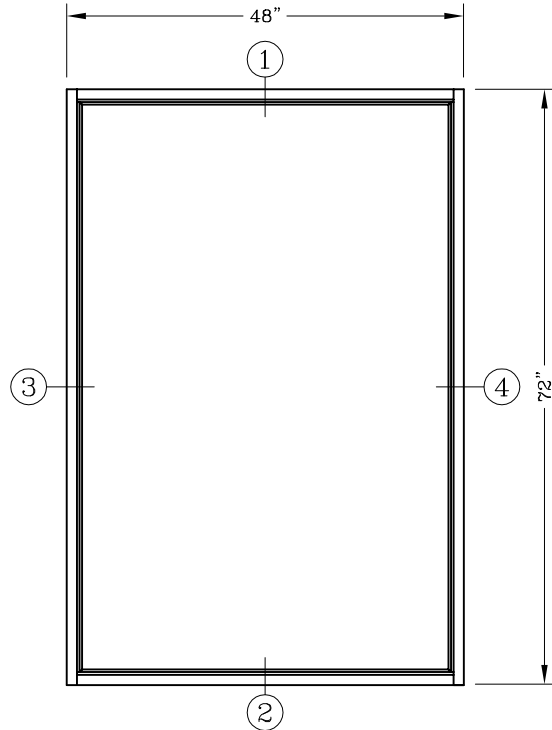

ELEVATION

48" x 72" Tested

INSTALLATION TYPES

1. Trim And Clip
 2. Receptor At Head And Jambs, And Sill Starter
 3. Pre-Set Panning And Trim Clip
 4. Wraparound Panning And Trim Clip
- (Reference Test Report #66275.01-109-18)

Window Dimension

